



DATASHEET

Cochlear™ Wireless Mini Microphone



Product Description

The Cochlear™ Wireless Mini Microphone transmits speech directly to your patient's sound processors from a range of up to 7 meters. It is:

- small
- lightweight
- portable
- wireless
- clip on (or worn with lanyard)

The Mini Microphone optimises signal-to-noise ratio in person-to-person communication. It sends the speaker's voice directly into the patients' sound processors without the need for any extra devices – no cables, cords or necklaces. It is effortless, reliable and improves speech understanding in difficult listening situations where distance, background noise or poor acoustics is an issue. And since the listener is not required to look directly at the speaker during a conversation, he or she is free to perform dual attention tasks that normal hearing people take for granted.

In essence the Mini Microphone extends the hearing range well beyond the reach of any sound processor in a variety of situations, such as when having conversations:

- at home
- in the car
- while dining out

The Mini Microphone also functions as a portable audio streaming device. Via its plug-and-play line input connector, your patient can connect to virtually any audio source, e.g. music player, PC, phone, or even TV to stream audio directly to the sound processors. It is ideal for situations such as:

- watching TV at a friend's house
- listening to a music player while exercising
- skypeing or using other online communication

Easy to connect

- Just press the pairing button on the Mini Microphone and turn on the sound processor within 20 seconds and it automatically pair with the sound processor.
- Pairing can also be done through the Cochlear Fitting Software.
- Once paired the Mini Microphone will stay paired with the sound processor.

Easy to use

- Simply turn the Mini Microphone ON and switch the sound processor into streaming mode.
- Easy to recharge using the included charger.
- Talk time 8.5 hours.
- Small and lightweight clip-on or lanyard worn device, no extra devices or cables needed.
- Plug-and-play line-in functionality.
- Volume control adjustment for personal preference.

2.4 GHz wireless Technology

- A smart, robust and reliable standard that has a strong, clear and stable signal.
- No synchronisation issues between sound and image due to an unnoticeable 20ms delay.

Hear now. And always



Cochlear®

Description

Article numbers:
94780 Cochlear Wireless Mini Microphone, EU
94781 Cochlear Wireless Mini Microphone, US
94782 Cochlear Wireless Mini Microphone, GB
94783 Cochlear Wireless Mini Microphone, AUS

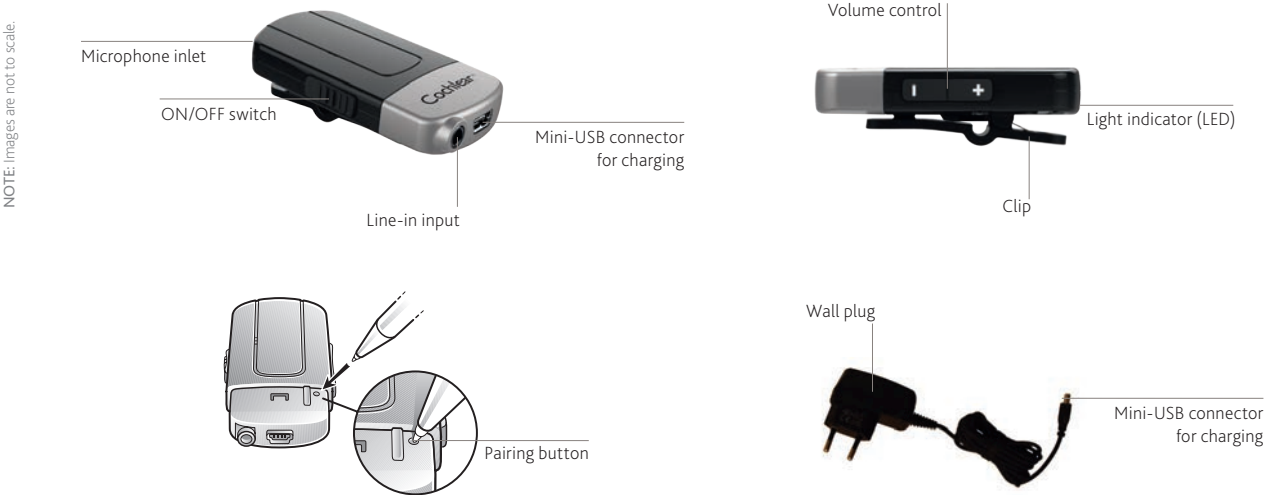

Technical information

Dimensions	62 x 34 x 17.5 mm
Weight	21 g
Power supply	External wall adaptor, 5 V DC
Power connection	Mini USB
Audio interfaces	Line-in connector
Line input sensitivity (nominal)	25 mV
Wireless connections	Multiple sound processors per Mini Microphone. Up to 3 streaming devices (combination of Mini Microphones and TV Streamers) plus one Remote Control and one Phone Clip per binaural set of sound processors.
Streaming range	Up to 7 m
Streaming latency	20 ms
Audio bandwidth:	
Microphone	300 Hz - 5 kHz
Line-in	20 Hz - 9.4 kHz
Wireless frequency	2.4 GHz
Emission	-4 dBm
ESD tolerance	6 kV HBM
Operating temperature	0 to +45 °C. May be used also in environments below 0 °C with reduced battery lifetime
Storage temperature	-20 to +45 °C, do not expose to direct sunlight

All data is subject to change.
Cochlear, Hear now. And always, Hybrid, Nucleus, SmartSound, the elliptical logo, Nucleus in Chinese characters and Codacs, are either trademarks or registered trademarks of Cochlear Limited. Ardiun, Baha, Baha Divino, Baha Intenso, Baha PureSound, Baha SoftWear, Dermalock, Vistafix and WindShield are either trademarks or registered trademarks of Cochlear Bone Anchored Solutions AB. © Cochlear Bone Anchored Solutions AB 2013. All rights reserved. SEP13. Printed in Sweden.

Manufacturer:
Cochlear Bone Anchored Solutions AB Konstruktionsvägen 14, SE - 435 33 Mölnlycke, Sweden
Tel: +46 31 792 44 00 Fax: +46 31 792 46 95

Regional offices:
Cochlear Ltd (ABN 96 002 618 073) 1 University Avenue, Macquarie University NSW 2109, Australia Tel: +61 2 9428 6555 Fax: +61 2 9428 6352
Cochlear Americas 13059 E Peakview Avenue, Centennial, CO 80111, USA
Tel: +1 303 790 9010 Fax: +1 303 792 9025
Cochlear AG EMEA Headquarters, Peter Merian-Weg 4, 4052 Basel, Switzerland
Tel: +41 61 205 0404 Fax: +41 61 205 0405